

We have these maps for any part of Manitoba, Saskatchewan and Alberta. Also mailing lists of all kinds. Write us for map making, mounting, draughting, etc.

Price \$1.00 Paper Copy

Price \$1.50 Cloth backed Copy. (Any number of Maps can be mounted in one piece making one large map.)

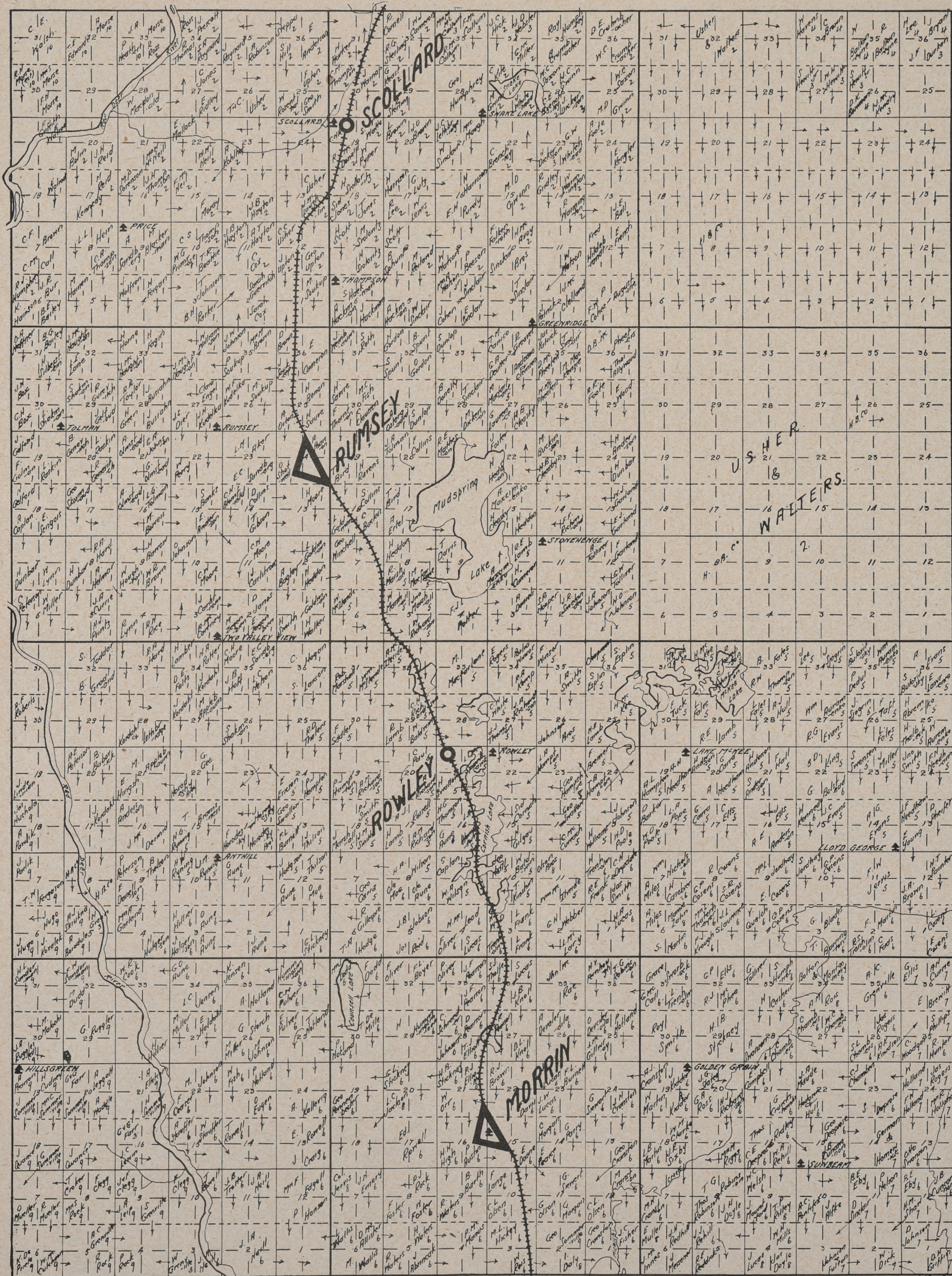

Tp. 34

Tp. 33

Tp. 32

Tp. 31

1. RUMSEY 2. SCOLLARD R. 21 3. BIG VALLEY 4. GOPHER HEAD 5. ROWLEY 6. MORRIN 7. MICHIGI R. 20 W. of 4 M. 8. MUNSON 9. GHOST PINE CREEK 10. ELNORA R. 19 CUMMINS MAP CO. WINNIPEG, MAN. No 92

LEGEND: ↑ Schools □ Cities □ Towns △ Villages ○ Post Offices ● Sidings
Number below owners name refers to Post Office address, which follows same number at bottom of Map